

A15-5 Menara UOA Bangsar
No 5 Jalan Bangsar Utama 1
59000 Kuala Lumpur, Malaysia.
Tel: +603-27103970
E-mail: admin@suryanautika.com.my

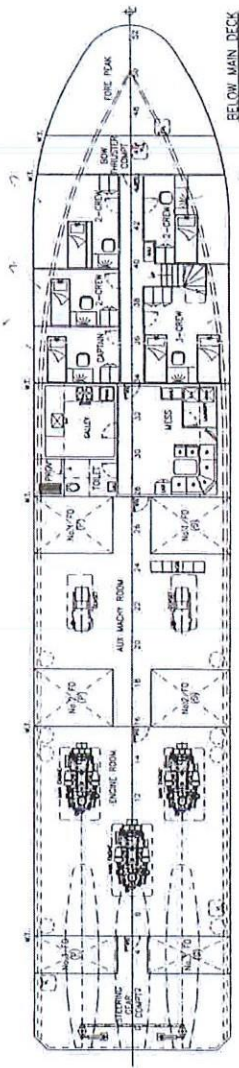

No	Item	Specification	No	Item	Specification
01.	Name	Padas	23.	Propulsion Machinery	
02.	Type of vessel	Utility Crew Boat		a) Main Engines	3 x 1400BHP Caterpillar C-32
03.	Design Characteristics	Aluminum		b) Propulsion	3 x Fixed Pitch Propellers
04.	Plying Limit	Near Coastal		c) Bow Thruster	1 x 100 Hp
05.	Classification	BV	24.	Navigation & communication Equipment	
06.	Notation	+A1, HSC , +AMS		a) Gyro Compass	1 x Anschotz
07.	Port of Registry	Kota Kinabalu		b) GPS	1 x Furuno GP-150
08.	Flag	Malaysia		c) Radar	1 x Furuno FR-1500 Mark 3, 1 x Furuno 1932 Mark 2
09.	Designer	Sam Aluminium S'pore		d) Echo Sounder	1 x Furuno FE- 700
10.	GRRT	270		e) Marine VHF	1 x Furuno FM-8800D, 1x Motorola GM 388
11.	NRT	81		f) Marine SSB	1 x Furuno FS-2570 (250w)
12.	Year Built	Oct 2007		g) Auto Pilot	1 x Anschotz Nautopilot NP-60
13.	Builder	Sam Aluminium S'pore		h) Directional Finder	GMDSS Furuno DMC-5
14.	IMO Number	9463683		i) Magnetic Compass	1 x White Star , Italy
15.	Distinctive No and letter	332291 / 9WIN2		j) Wind Speed/Dir	1 x Fitted
16.	Horse Power	4200 BHP		k) Chart Plotter	1 x Furuno
17.	Performance			l) Navtex	1 x Furuno NX-700
	a) Cruising Speed	25 knots		m) Steering	Dual hydraulic, (main system AC, emergency hand)
18.	Fuel consumption			n) Search Light	Maxi 1000 watts x 3, (two forward one aft)
	a) Cruising	435 liters/hr	25.	Accommodation	Fully air conditioning for 50 reclining ferry seat with individual and 9 crew complement
	b) Gen-Set	8 liters/hr		a) Seating	Business Class Sitting 50 pax
19.	Main Characteristics			b) Hospital	Deck access to Hospital
	a) L.O.A	40.37		c) Toilet	Separate Toilet for Passengers
	b) Beam Molded	7.50 M		d) Entertainment	1 x 29", 2 x 21" TV linked to CD/DVD player
	c) Draft Designed	2.30		e) No of Bunks (11)	1 x 1 man cabin (VIP) 1 x 1 man cabin (Master) 3 x 2 men cabin 1 x 3 men cabin
	d) Loaded Displacement	210 Ton	26.	Fire Fighting Equipment	
	e) Lightship	90 Ton		a) Fire Hydrant Station	As per Classification's requirement
20.	Capacity			b) Fire Extinguisher	Potable type at appropriated location
	a) Fuel Oil	103.06 M3		c) Fixed System	Co2 smothering system for engine room protection
	b) Fresh Water	19.49 M3			
	c) Clear Deck Space	100 Sqm	27.	Life Saving Appliances	As per SOLAS 74/78, Port of Registry and Classification's requirement
	d) Deck Cargo	1.5 ton/sqm			
	e) F.W	35cu m	28.	Other Equipment	
	f) F.W Pumping Capacity	20 cu m per hour at 40 m head		a) Life raft	2 x 25 persons, 2 x 50 persons inflatable life raft c/w automatic hydrostatic release
	g) Diesel oil	75 cu m		b) Rescue Boat	1 x 6 Semi-Rigid rescue boat c/w Yamaha 25 hp outboard engine
	h) Diesel oil Pumping capacity	20 cu m per hour at 40 m head			
21.	Auxiliaries	2 x Pekins 92.5 kw (124 BHP)			
22.	Pump				
	a) Main Bilge and Fire Pump	Desmi S70-50-220/A09, 25 m3/hrs at 30 m head			
	b) Back Up Bilge and Fire Pump	Desmi S70-50-220/A09, 25 m3/hrs at 30 m head			
	c) Emergency Fire Pump	Kipor KD8-20, 600 ltrs/hr at 22 m3/hr at 30 m head			

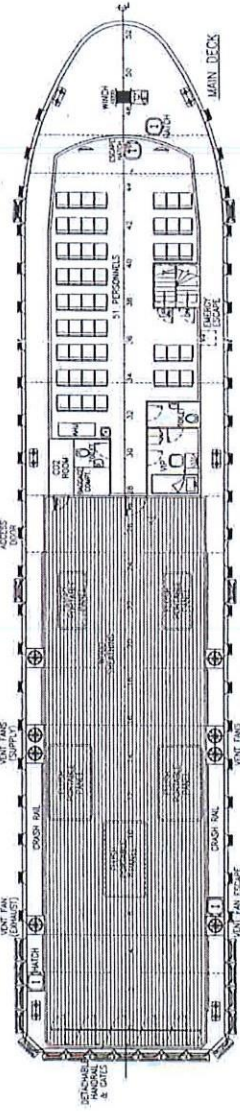
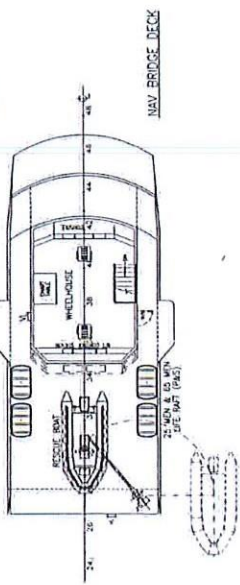
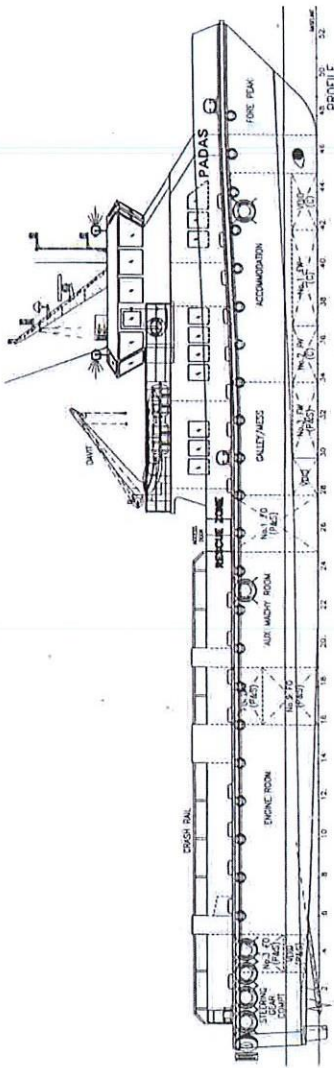

PRINCIPAL DIMENSIONS
 LENGTH OVERALL ----- 40.327 m
 LENGTH WATERLINE ----- 38.024 m
 BREADTH MOULDED ----- 7.80 m
 DEPTH MOULDED ----- 3.40 m
 DESIGN DRAFT (MID) ----- 1.30 m
 PERSONNEL ----- 51

9	REVISED AS PER FITTED	SLP	21/11/08
8	REVISED AS PER FITTED	CHEN JIN	30/08/07
Rev	Authorisation	By	Date
SAM ALUMINIUM ENGINEERING PTE LTD 27, Jalan Pagar Besar, Singapore 108765 Tel: 65 6341 7335 Fax: 65 6346 2002 E-mail: sam@samalastic.net.sg www.samalastic.com			
Client	ABS	Ref	07/078
Contract	SASASHIP PTE LTD	Project	SKK
Project	40m UTILITY CREWBOAT	Issue	06/11/08
Sheet	GENERAL ARRANGEMENT	Drawn by	TONY SET
Scale		Checked by	06/11/08
Drawn		Issue No	P0641-C1
Sheet		Of	9

Approved By :
 On :