

# SURYA SUBANG

## FAST CREW BOAT



**A15-5 Menara UOA Bangsar**  
**No 5 Jalan Bangsar Utama 1**  
**59000 Kuala Lumpur, Malaysia.**  
**Tel: +603-27103970**  
**E-mail: admin@suryanautika.com.my**



### PRINCIPAL PARTICULARS

Port Of Registry : Port Kelang  
 Call Sign : 9MIE7  
 IMO No. : 9541605  
 Official No. : 333980  
 Year Built : 2008  
 Class : Bureau Veritas (BV)  
 Notation : 1✕ Hull ✕ Mach HSC – Cat A, Coastal Waters  
 Type : Fast Crew Boat  
 Flag : Malaysia  
 Owner : Surya Nautika Sdn Bhd  
 Operator : Surya Nautika Sdn Bhd

### DIMENSION

Length Overall : 34.00 m  
 Length Registered : 31.49 m  
 Breadth Moulded : 7.83 m  
 Depth Moulded : 3.30 m  
 Draft Moulded : 1.50 m  
 Summer freeboard : 1.735 m  
 GRT : 226 mt  
 NRT : 67 mt  
 Deadweight : 44 mt

### PERFORMANCE

Speed : 20.0  
 Type of fuel : Marine Gas Oil

### CARGO CAPACITIES

Deck Cargo : +/-40 mt  
 Deck Strength : 2.5 Ton/m<sup>2</sup>  
 Clear Deck Area : 65.10 m<sup>2</sup> (6.2m x 10.5m)  
 Fuel Oil : 50 m<sup>3</sup>  
 Fresh Water : 20 m<sup>3</sup>  
 Sludge Tank : 250 ltrs  
 Dispersant tank : 200 ltrs  
 Cargo railing height : 1.5m

### PROPULSION SYSTEM

Main Engine : 3 x 1450 BHP @ 2300 rpm Caterpillar C32  
 Main Generator : 2 x 75 kW Cummins 6BT5.9 DM  
 Bow Thruster : 1 x 1 Ton Thrust  
 Steering Gear : 1 x Kobelt 7175 MA (electrohydraulic)  
 Propulsion : 3 x 5 Bladed FPP of Nickel Aluminum Bronze  
 Rudders : 2 nos

### DECK EQUIPMENT

Anchor Winch : Electrical, single drum and warping head  
 1 ton nominal pull at 9m/min  
 Anchors : High Holding Power type, 1 x 135kg (approx.)  
 Chains : Steel wire rope (length and breaking strength as required by Class) c/w 12.5m x 14mm dia. stud link chain  
 Bollards : 6 x 100mm dia. double-bit / 2 x 100mm dia. single bit  
 Mooring Chocks : 4

### FIRE FIGHTING EQUIPMENT

#### External

Fire monitor : 2 units fitted on the port and starboard side aft (stern) on the main deck.  
 Fire pump : 300m<sup>3</sup>/hr (Volvo Penta – Standalone unit)

#### Internal

Fixed System in E/R : Aerosol Fire Suppression System  
 Fire Detection System : Fire Alarm Panel ASM Syncro  
 Emergency Fire Pump : Desmi 50m<sup>3</sup>/hr Electric Motor Driven  
 Fireman's outfit : 2 units complete with breathing device  
 Fire blanket : 3 nos.

### NAVIGATIONAL /COMMUNICATION EQUIPMENTS

GMDSS : 1 set T&T  
 SSB : 1 set Sailor 6301  
 SART : 2 x JOTRON-TRONSART20  
 EPIRB : 1 set JOTRON – TRON 60S  
 Inmarsat C : 1 set T&T Sailor  
 VHF Radio : 1 x T&T RT5022 & 1 x ICOM IC-M323  
 Portable VHF Radio: 3 x handheld VHF, 2.5W, I.S. type c/w spare battery & charger – Sailor SP3520  
 Satellite Phone/fax : 1 unit Mini-M  
 Navtex Receiver : 1 x SAMYUNG – SNX 300  
 X-Band Radar : 1 x Furuno FR 2117, 1 x Furuno 1715  
 Echo Sounder : 1 x Skipper, ED165  
 GPS : 1 x Koden – KGP - 920  
 Gyro compass : 1 x Anschutz  
 Autopilot : 1 x Anschutz NP60  
 Speed Log : 1 x Anthea  
 Magnetic Compass : 1 set RITCHIE c/w reflector  
 AIS : 1 x Furuno – FA 150

### ACCOMMODATIONS

Berths : 10 berths for marine officer/crew  
 Passenger Seating : 50 persons  
 \*All cabins are fully air-conditioned

### LIFE SAVING APPLIANCE

Search Lights : 2 x 1000W  
 Liferafts : 6 x 25 Men SOLAS Type  
 Lifebuoys : 8 pcs  
 Life jackets : 63 pcs  
 Work Vest : 8 units  
 EEBD : 2 units  
 Line Throwing Apparatus : 4 projectiles and lines  
 Scrambling net : 2 units (4m x 3m)  
 Rescue boat : 1 inflatable rescue boat for 6 men with 25HP outboard motor & launching davit

### AUXILLIARY SYSTEM

Rescue Zone : Port & Starboard at Main deck  
 Oily Water Separator: 1 nos. of 0.5t/hr- Georim

# BAYCORP SUBANG

## PRINCIPAL DIMENSIONS

LENGTH O.A. (Hull) \_\_\_\_\_ 34.00 M  
 LENGTH W.L. \_\_\_\_\_ 31.67 M  
 BREADTH MLD \_\_\_\_\_ 7.85 M  
 DEPTH MLD \_\_\_\_\_ 3.30 M  
 DRAFT (Maximum) \_\_\_\_\_ 1.50 M

COMPLEMENT \_\_\_\_\_ 10 CREW  
 \_\_\_\_\_ 50 PERSONNEL

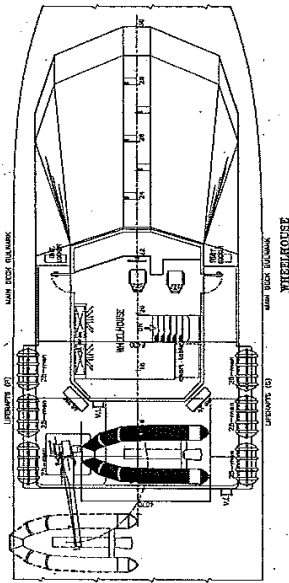
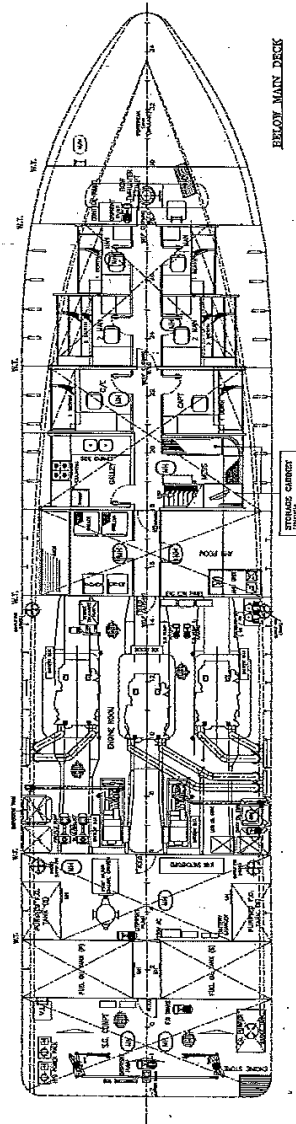
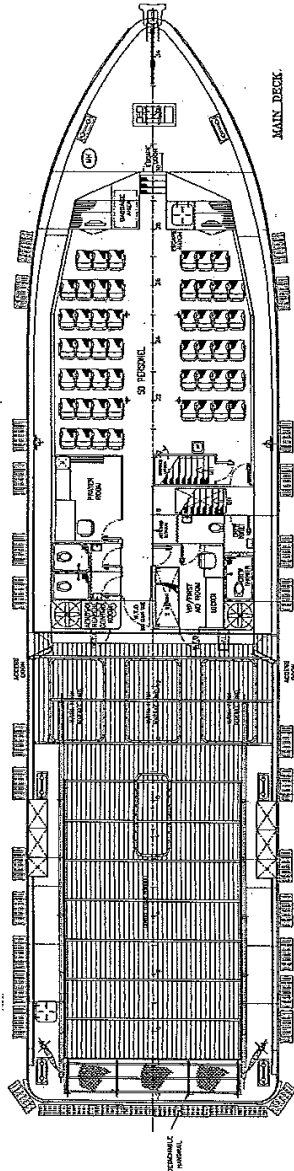
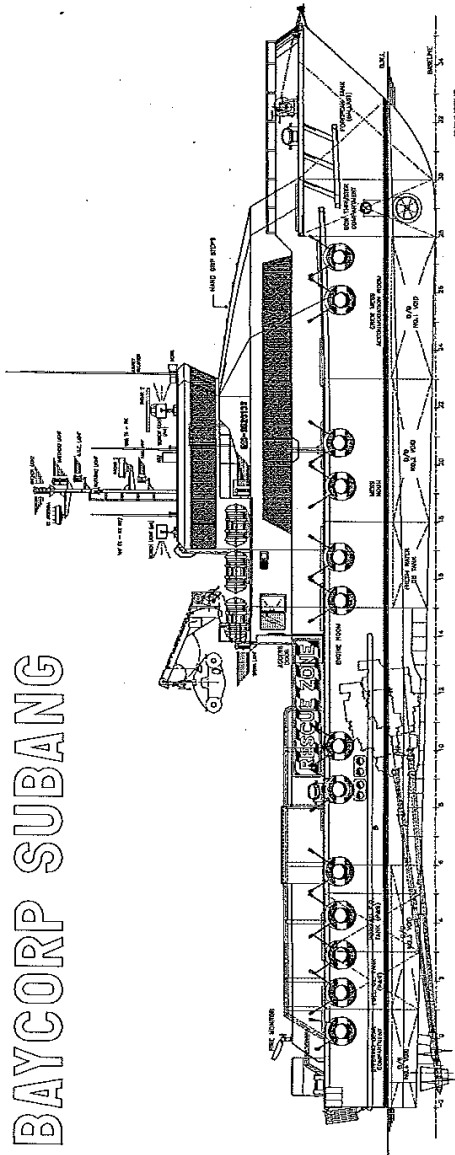

LATEST DESIGN NOTIFICATIONS		DATE	BY
APPROVED BY THE TYPE APPROVAL OFFICER		DATE	BY
PROJECT :		NGV TECH SDN BHD	
PROJECT :		GAGASAN CARRIER SDN BHD	
PROJECT :		34M FAST OFFSHORE CREWBOT	
TITLE :		GENERAL ARRANGEMENT	
HULL NO. :		1081	
SCALE :	DATE :	SCALE :	DATE :
20:00:00	27:06:05	20:00:00	27:06:05
DRAWN :	BY :	DRAWN :	BY :
1:1M	1:1M	1:1M	1:1M
APPROVAL :		175	
SHEET :		1 OF 1	